

x2

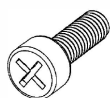

x2

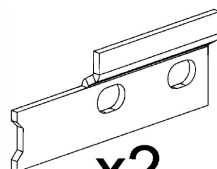

x2



x4

Le viti per l'installazione a parete non sono incluse.
Selezionarle in base al tipo di parete a cui viene fissato il prodotto.

Fori a parete

W= Larghezza

H= Altezza

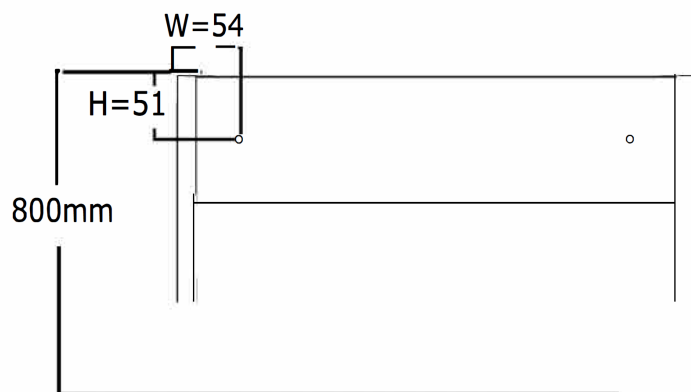

Regolazione del cassetto

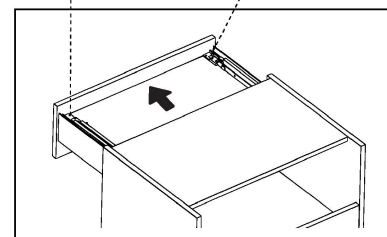
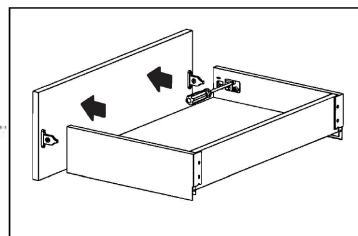
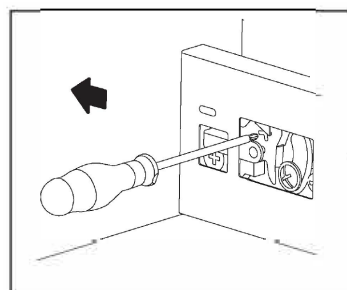
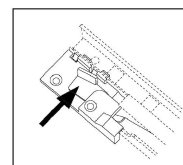
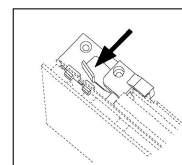
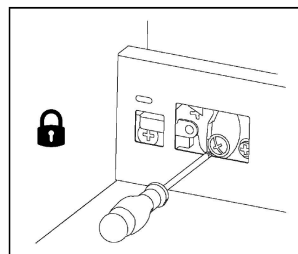
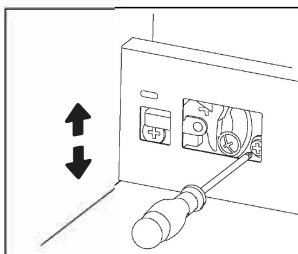
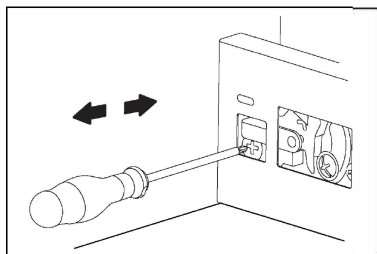

Manutenzione e pulizia

Pulire il prodotto con un panno umido o con detergente non abrasivo.
Tenere asciutta la superficie del prodotto con un panno pulito al fine di evitare infiltrazioni o umidità.